

## **LEAD INGOTS FEEDER Type CL**

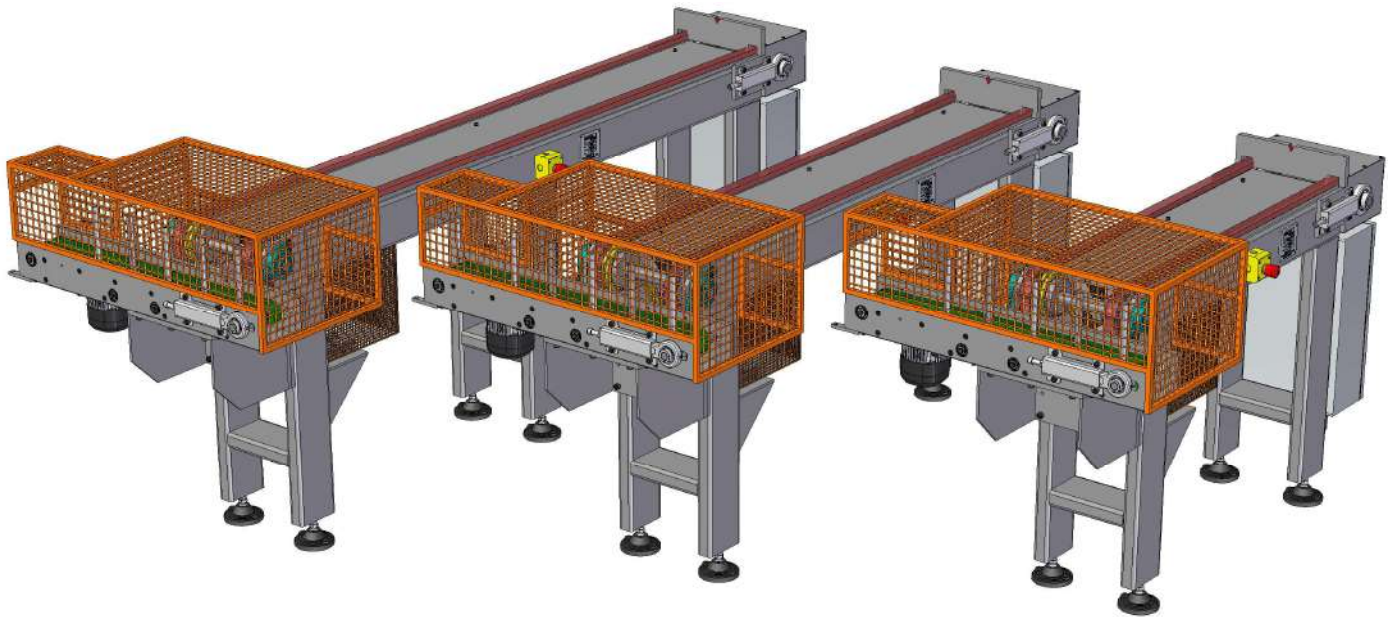

- The feeder is fully automatic.
- Applicable to any of melting pot.
- Secondary belt with right or left orientation.
- Chain conveyor to storage and transfer the lead ingots to the pot.
- Timers to change the loading frequency of the melting pot.
- Slide to introduce the ingots in the melting pot.
- Sensor lead level and float applied to the melting pot.
- Electrical control panel.
- Available in three standard sizes with storage capacity 10 – 15 – 20 ingots.

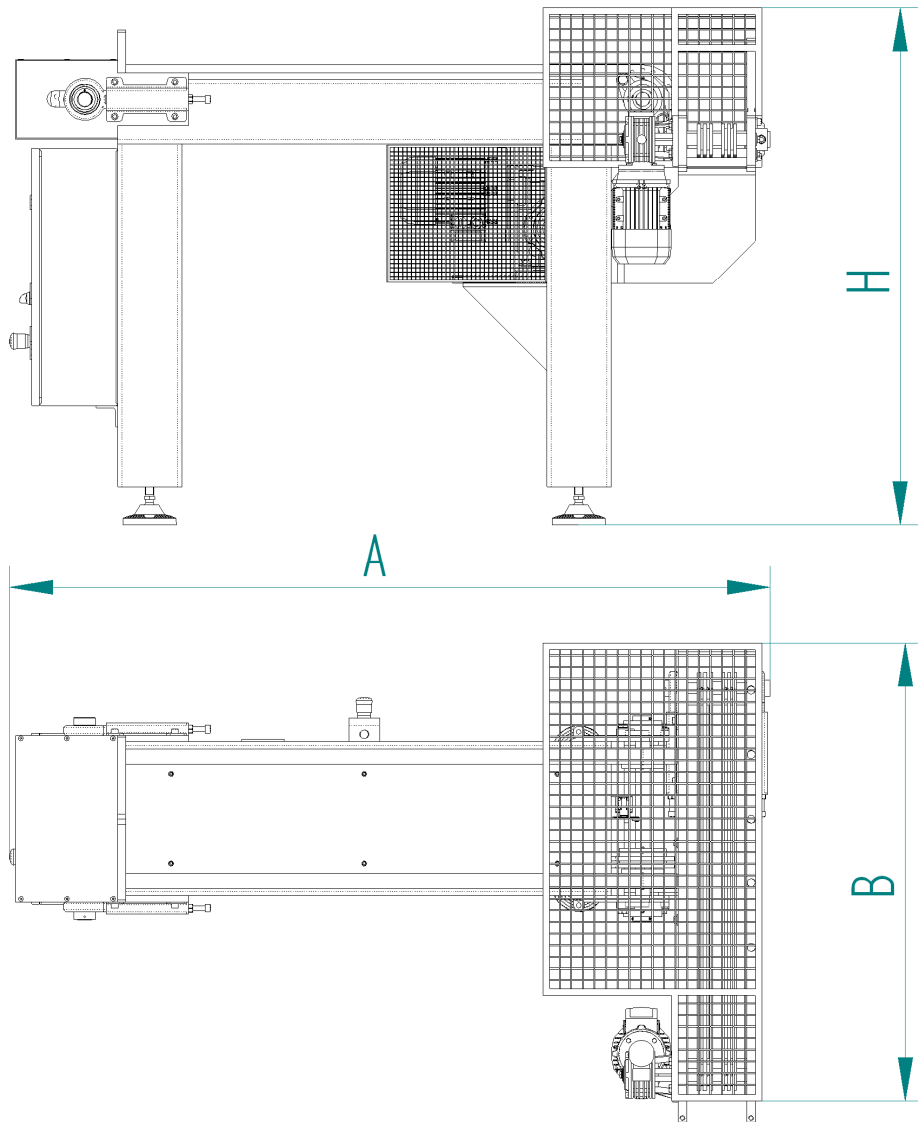

|  | <b>"CL10"</b>             | <b>"CL15"</b>             | <b>"CL20"</b>             |
|--|---------------------------|---------------------------|---------------------------|
| <b><u>Dimensions A x B x H (mm):</u></b> | <b>1770 x 1070 x 1200</b> | <b>2370 x 1070 x 1200</b> | <b>2970 x 1070 x 1200</b> |
| <b><u>Weight:</u></b>                    | <b>~ 425 Kg</b>           | <b>~ 460 Kg</b>           | <b>~ 525 Kg</b>           |
| <b><u>Storage Capacity:</u></b>          | <b>10 ingots</b>          | <b>15 ingots</b>          | <b>20 ingots</b>          |
| <b><u>Power Supply:</u></b>              | <b>380V – 50Hz</b>        | <b>380V – 50Hz</b>        | <b>380V – 50Hz</b>        |
| <b><u>Installed Power:</u></b>           | <b>1,5 Kw</b>             | <b>1,5 Kw</b>             | <b>1,5 Kw</b>             |

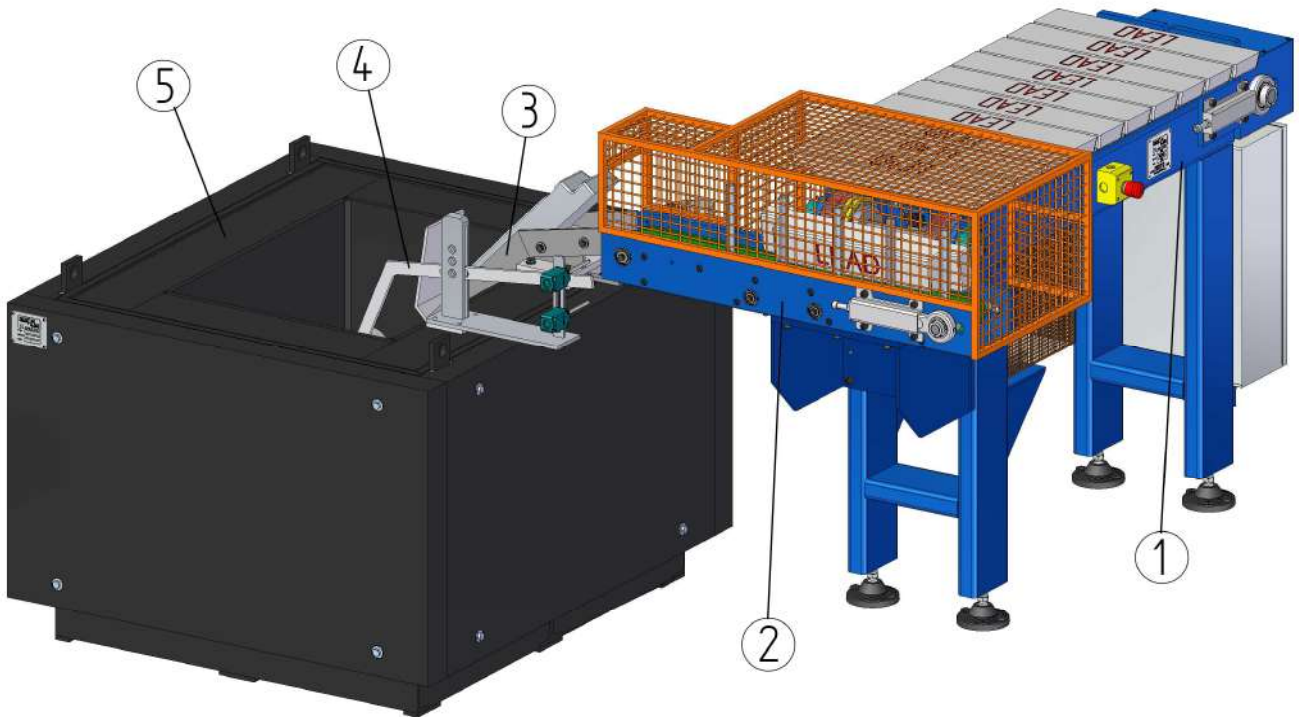

|          |                                     |
|----------|-------------------------------------|
| <b>1</b> | <b>PRIMARY BELT</b>                 |
| <b>2</b> | <b>SECONDARY BELT</b>               |
| <b>3</b> | <b>SLIDE INGOTS</b>                 |
| <b>4</b> | <b>FLOAT WITH SENSOR LEAD LEVEL</b> |
| <b>5</b> | <b>MELTING POT</b>                  |

*WE RESERVE ANY POSSIBLE MODIFICATIONS*